

# KINGSTON

KITCHEN & BATH

## INSTALLATION INSTRUCTIONS

### Wall Mount Shower Seat

#### Need Tools:

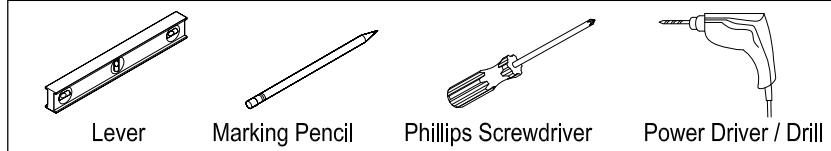

#### Typical installation:

The typical shower wall surround may be a 2x4 wood stud frame, covered with gypsum drywall, tile board or plaster. The shower wall finish is usually ceramic tile. These materials alone are not adequate to support the fold down seat unless you can mount into existing wood blocking or wall studs. You can use a 1/8th-inch masonry bit, drill through the tile grout to determine if studs are in place.

#### Strong wall support is required:

Installation of the wall mounted folding shower seat requires wood blocking in a typical stud wall. We suggest installing continuous 2 x 12 wood blocking between the studs, starting from the floor plate up to at least 24 inches above the shower floor. Remodeling an existing shower can be more involved. If the shower backs up to an interior wall, consider removing the wallboard and installing the blocking from the backside. If not, it may be required to remove and replace a portion of the existing shower wall tile.

#### Anchoring hardware requirements:

Once the wood blocking is in place and the wall finish has been installed, position the shower seat at the required height, normally 17-19 inches above the floor. Use a marker to mark the flange and wall bracket screw locations. Use a punch and hammer to carefully nick the tile to prevent the drill bit from wandering. Use a masonry bit and drill through the tile. All anchoring hardware must be carefully selected to insure proper installation.

**OUR SHOWER SEATS ARE ONLY AS STRONG AS THE MOUNTING HARDWARE CHOSEN AND THE WALLS ON WHICH THEY ARE MOUNTED.**

#### SAFETY NOTE:

**Concealed In-Wall support backing is ALWAYS REQUIRED for this product (not included) - and must be supplied and selected by a Licensed installer/contractor to meet both weight bearing and local code requirements.**

**PRODUCT INSTALLATION SHOULD BE DONE BY A LICENSED INSTALLER/CONTRACTOR.**

#### CAUTION:

**Personal injury and/or property damage may result from improper wall support or mounting, which is not covered under warranty.**

#### Please Read Disclaimer

The manufacturer or distributor of this product shall not be held liable for installation actions taken or not taken. There are many details of installation that are assumed to be general construction knowledge to experienced installers; which are not included in these instructions. Selection of an experienced installer is the sole responsibility of the home owner or architect.



Failure to follow all installation directions may cause product to detach from the wall and cause serious injury



ADA Compliant

[www.kingstonbrass.com](http://www.kingstonbrass.com)

TOLL-FREE CUSTOMER SERVICE: 1-877-2-KBRASS

TECHNICAL SUPPORT E-mail: [service@kingstonbrass.com](mailto:service@kingstonbrass.com)

12775 Reservoir Street, Chino, CA 91710

# KINGSTON

KITCHEN & BATH

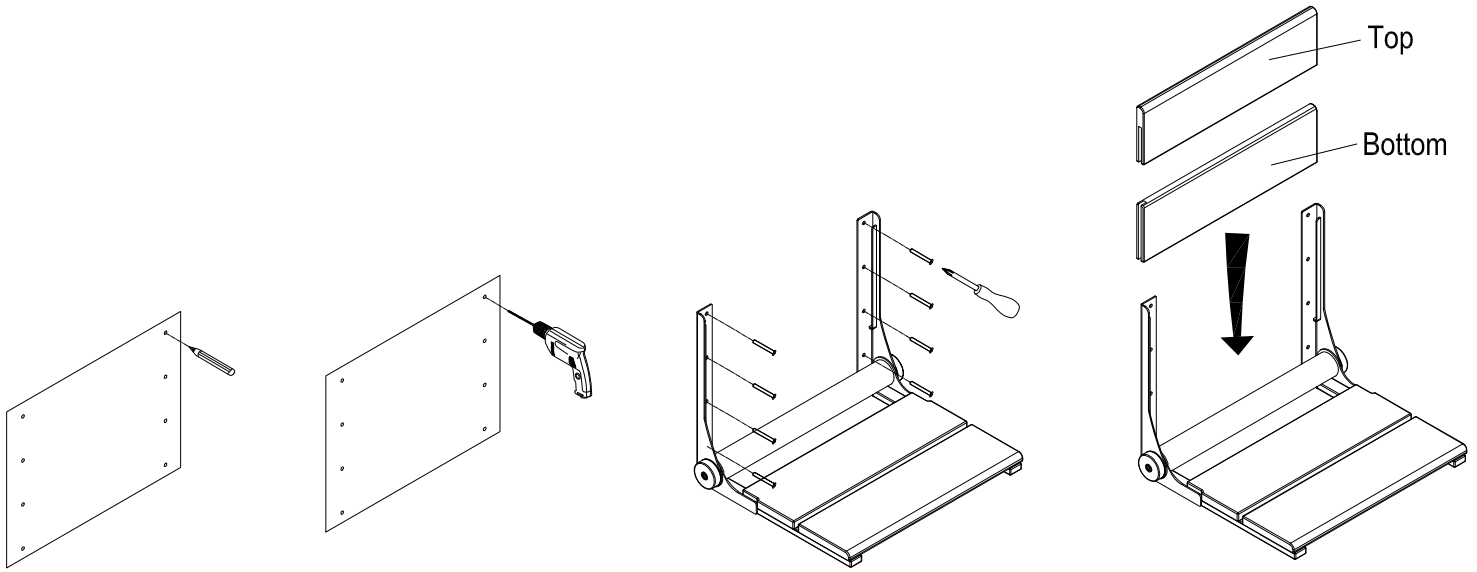

## INSTALLATION STEPS:

1. Confirm contents of box: 1 Shower seat & 8 stainless steel screws& L shaped wrench.
2. Test seat up / down movement, then set in down position and carefully consider the following before installing:
  - Adjust Mounting Locations:  
Install only where there is proper structure support within the wall. Measure area on the wall of seat in the up/collapsed position, to avoid hitting other objects. Also avoid pipe/wires/grout/etc.
  - Adjust Height:  
To meet local building codes and ADA requirements, height from top of seat (in lowered / in-use position) to finished floor must be between 17" to 19".
  - Adjust To Be Level:  
Seat must be flat (not angled to one side)
3. After final adjustments, position mounting flanges close to shower wall and mark each hole location with pencil.
4. Drill pilot holes.
5. IMPORTANT:  
WALLS MUST HAVE PROPER CONCEALED IN-WALL BACKING INSTALLED BY A LICENSED INSTALLER/CONTRACTOR BEFORE INSTALLING PRODUCT.
6. Unscrew the side screws on the backrest, Remove the upper backrest seat slat; It will easily slide out.
7. Install the seat with the manufacturer,s provided screws. Insert the backrest seat slat in sequence bottom / top, and lock the screws on the side.
8. Test seat by applying gradual pressure.

## Maintenance:

Clean with mild soap and water.

## Warranty:

Full 1 year warranty for material defects and manufacturing defects.