

KINGSTON

KITCHEN & BATH

Grab Bar Installation

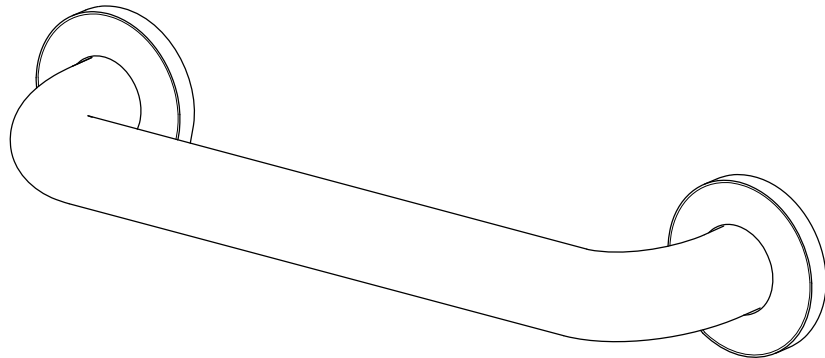

Parts:

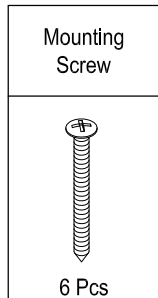

MODEL	FINISH
CS	Stainless Steel, with Cover
CT	Stainless Steel, with Cover, Textured
ES	Stainless Steel, without Cover
ET	Stainless Steel, without Cover, Textured

CAUTION

Failure to follow all installation directions may cause product to detach from the wall and cause serious injury

www.kingstonbrass.com
 TOLL-FREE CUSTOMER SERVICE: 1-877-2-KBRASS
 TECHNICAL SUPPORT E-mail: service@kingstonbrass.com
 12775 Reservoir Street, Chino, CA 91710

TOOLS REQUIRED



Marking Pencil

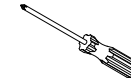

Phillips Screwdriver

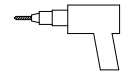

Power Drill

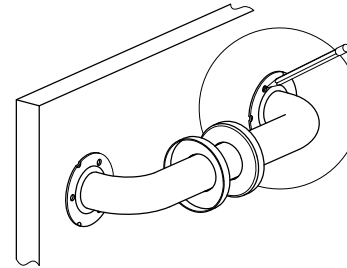

Fig. 1

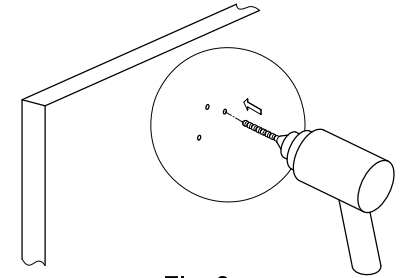

Fig. 2

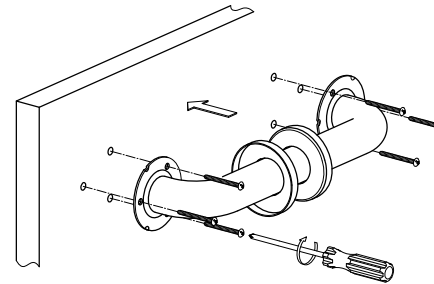

Fig. 3

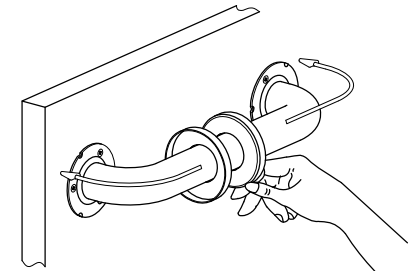

Fig. 4

Installation Steps:

1. Locate position on the wall and mark location of the holes.
2. Drill Starter holes (5/64").
3. Mount grab bar to the wall using 2" screws (Enclosed).

This grab bar is designed to be installed on wood bracing, if a proper wood bracing is not available consult your contractor as to the best anchors to use for your specific application some options available are Tile/ masonry anchors, toggle bolts, plastic anchors, metal anchors and drywall anchors.

Cleaning

Clean with a damp cloth only.
 Avoid using metal or abrasive polishes.